

# SQUBE on track

CEILING SURFACE

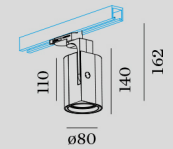

## 3.0 LED

LED 20W | 220-240VAC | 50-60Hz  
 COB 3-step | incl. PS | phase-cut dim  
 aluminium powder coated  
 incl. 3-phase track adapter

0.75kg | IP20 | 0.3m | 31°

90° | 355°

CODE

White	144564W
Black	144564B

## Light Colour Selection

	LUMEN	CRI	CODE
2700K	1380	>80	2
3000K	1520	>80	4
1800-3000K	1500	>80	9
2700K	1250	>90	3
3000K	1360	>90	5

## OPTIONAL

dimmer

CODE

for switch	90019017
for din rail	90019018

more specs on page 576

more track accessories on page 588

for more support and planning of 3-phase track systems,  
please check our FAQ section on [weverducre.com](http://weverducre.com)

### TRACK PROFILE 1M surface

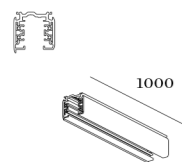

	CODE
	90014060
	90014061

### TRACK PROFILE 2M surface

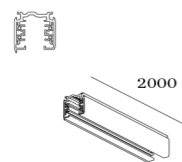

	CODE
	90014062
	90014063

### TRACK PROFILE 3M surface

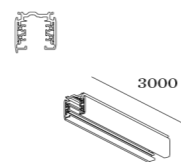

	CODE
	90014064
	90014065

### TRACK ADAPTER no space for driver for suspension power cable incl. strain relief



	CODE
	90014078
	90014079

### STRAIGHT CONNECTOR



	CODE
	90014080
	90014081

### END CAP end cap left / right



	CODE
	90014076
	90014077

### END FEED left



	CODE
	90014066
	90014067

### END FEED right



	CODE
	90014068
	90014069

### MIDDLE FEED straight

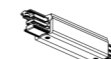

	CODE
	90014070
	90014071

### L-CONNECTOR left



	CODE
	90014072
	90014073

### L-CONNECTOR right



	CODE
	90014074
	90014075

# SQUBE 3.0 ON TRACK

12-Apr.-2017

## 3.0 LED

LED 20W | 220-240VAC | 50-60Hz | COB 3-step | incl. PS | phase-cut dim

CE IP20 0.3m 31° 90° 355°

white texture	144564W
black texture	144564B

### LIGHT COLOUR

2700K   >80CRI   1380lm	2
3000K   >80CRI   1520lm	4
2700K   >90CRI   1250lm	3
3000K   >90CRI   1360lm	5

### OPTIONAL

dimmer for switch	90019017
for din rail	90019018

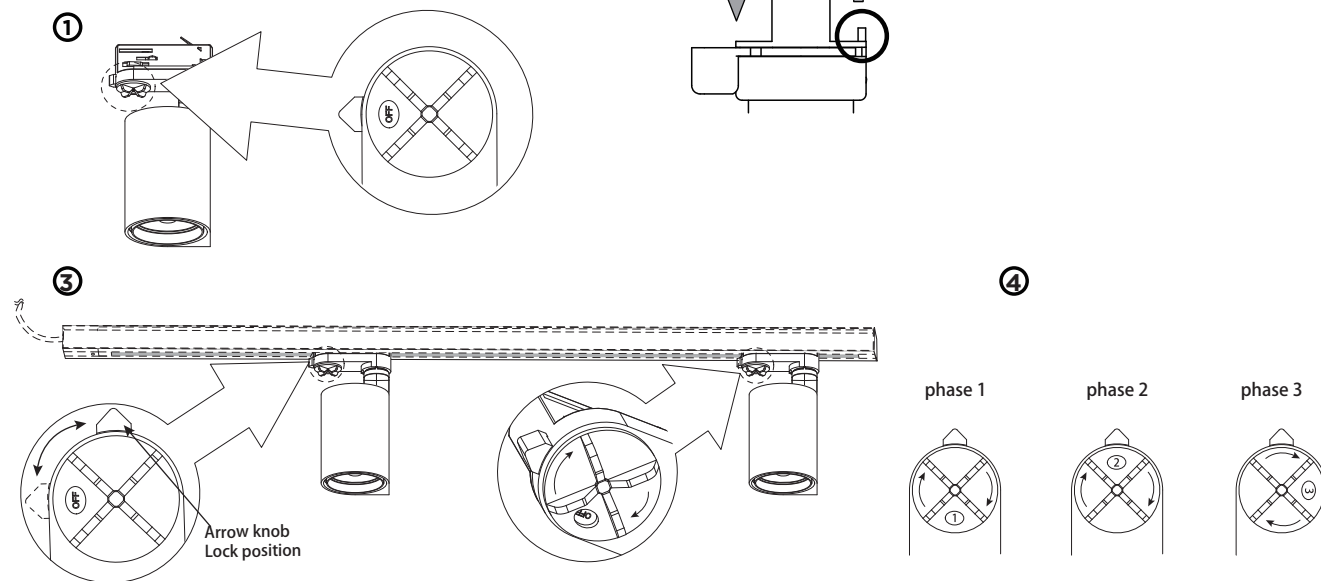

## DIMENSIONS

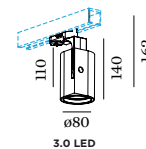

## MOUNTING INSTRUCTION

- ① Make sure the knob is on the OFF position.
- ② Push the fixture into the track.
- ③ Turn the knob to the Lock position.
- ④ Select the phase.

The light source of the integrated LED is not replaceable;  
When the light source reaches its end of life the whole  
luminaire shall be replaced.



Caution, risk of electric shock



WEVER & DUCRÉ  
LIGHTING

[www.weverducre.com](http://www.weverducre.com)

Wever & Ducre bvba Kwadestraat 153 bus 2.1 8800 Roeselare

INSTALLATION  
INSTRUCTIONS